

Support Plate Installation

The support plate used for installations in thinner walls such as fiberglass shower units is an integral part of the plaster guard and is installed on the body.

- 1 Break plaster guard off of support plate.
- 2 Make opening in thin wall to best utilize the support plate. A 3" hole is required.
- 3 Assemble screw through retaining clip and screw into support plate approximately two revolutions.
- 4 Push support plate onto body assembly against lugs.

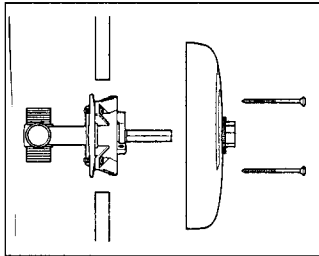

- 5 Install the valve body with the support plate through the hole in the fiberglass wall.
- 6 Tighten the retaining clip to hold support plate and body assembly in place against wall.
- 7 Secure the escutcheon to the valve body using the escutcheon screws provided with the body assembly.

The support plate with retaining clip holds the valve in place when plumbed with flexible tubing.

Sterling Limited Five Year Warranty

Sterling Plumbing Group, Inc. ("Sterling") warrants this faucet to be free of manufacturing defects and to be drip free for five years. Damage due to improper installation, maintenance or handling are not considered manufacturing defects and are not covered by this warranty. Labor, shipping and installation costs or other charges incidental to warranty service are to be borne by the original purchaser. This warranty is valid for the original purchaser only.

Sterling will, at its election, repair or replace a faucet where Sterling's inspection discloses any such defects occurring in normal residential usage.

To obtain warranty service return the defective part(s) to your cooperating retail seller or send them to our Customer Service Department, P.O. Box 427, Sheridan, AR 72150. Refer any questions to our Customer Service Department at 1-800-245-2207.

IMPLIED WARRANTIES INCLUDING THAT OF MERCHANTABILITY AND FITNESS FOR A PARTICULAR PURPOSE ARE EXPRESSLY LIMITED TO ONE YEAR FROM DATE OF PURCHASE. STERLING DISCLAIMS ANY RESPONSIBILITY FOR SPECIAL, INCIDENTAL OR CONSEQUENTIAL DAMAGES. Some states do not allow limitations on how long an implied warranty lasts, or the exclusion or limitation of special, incidental or consequential damages, so these limitations or exclusions may not apply to you. This warranty gives you special legal rights. You may also have other rights which vary from state to state.

This is our exclusive written warranty.

For more information on Sterling Faucets, please call 1-800-STERLING.

STERLING

A KOHLER COMPANY

INSTALLATION INSTRUCTIONS SINGLE CONTROL TUB / SHOWER MIXING VALVE

1

Before you begin

Use this diagram to familiarize yourself with the various parts of the tub / shower faucet. Make sure you have all the illustrated parts before you begin installation.

- Observe all local plumbing codes.
- Carefully inspect the valve parts for any damage.
- Flush all piping thoroughly before installing.
- Shut off hot & cold water supplies.

NOTE: For replacement installations, place a protective covering over bath. Remove old valve assembly. You may be able to use an access behind the bath.

NOTE: It is recommended that pipe joint compound be used on all metal threads. When sweating (soldering) copper directly to valve, use minimal heat to avoid damage to internal seals.

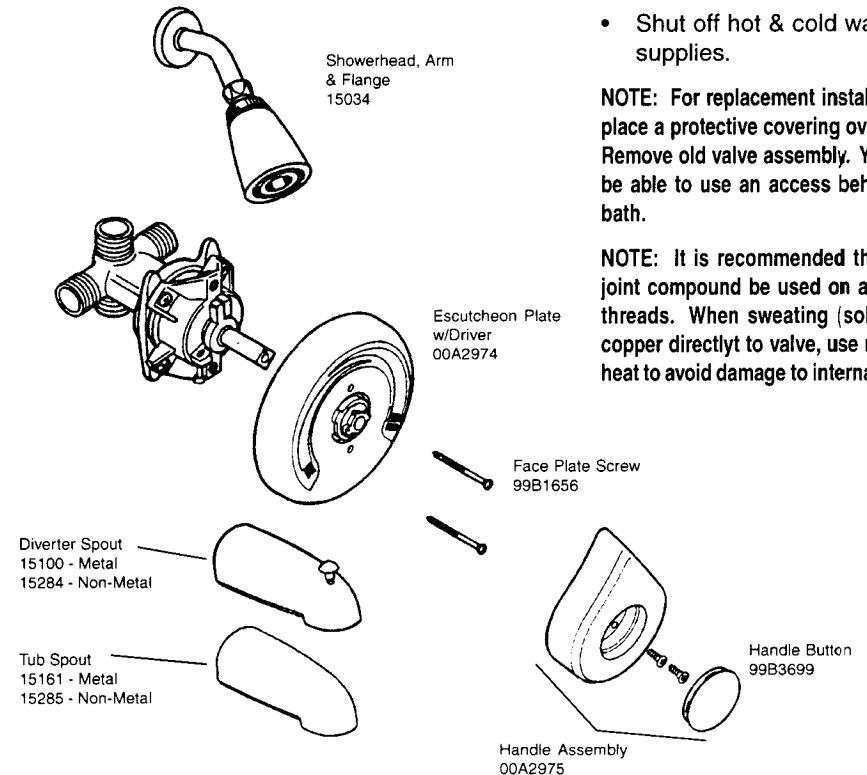

E043500

5/99

STERLING

A KOHLER COMPANY

P.O. Box 427, Oklahoma Street
Sheridan, Arkansas 72150-0427

E043500

TUB / SHOWER MIXING VALVE

2 Items you need

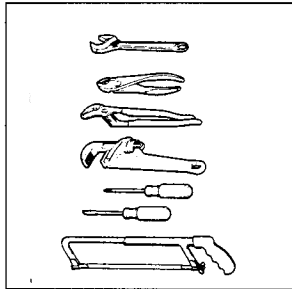

1 Adjustable wrench, pliers, channel lock pliers or pipe wrench, screw drivers hacksaw.

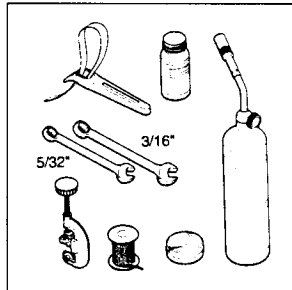

2 strap wrench, thread sealant, hex wrenches, tube cutter, flux and solder, propane torch.

MATERIAL

- 1/2" iron pipe or copper tubing
- 1/2" iron pipe or copper elbows
- 1/2" iron pipe couplings
- For copper: shower/bath elbows for mounting.

You may need the above materials

3 Note: If installation is made in regular wall, break off support plate from plaster guard and discard. If installed in a thin wall see step #7.

3 Installation prep

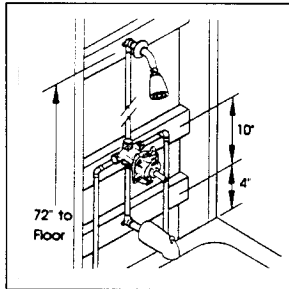

1 Tub & Shower Installation
NOTE: 2' x 6' wall construction

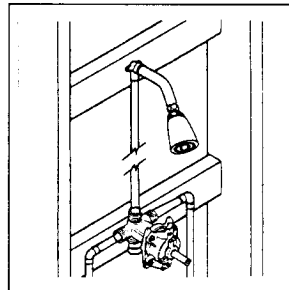

2 Shower only Installation
NOTE: 2' x 6" wall construction

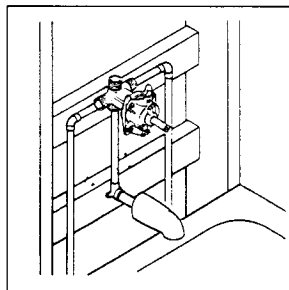

3 Tub Only Installation
NOTE: 2' x 6' wall construction

4 Valve installation

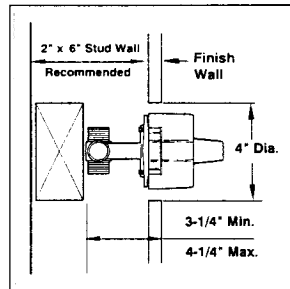

1 Make opening in existing wall large enough for working. A 4" diameter hole is required for valve.

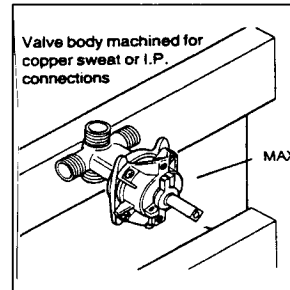

2 The "MAX" marking on plaster shield must be on top.

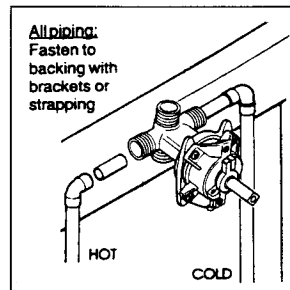

3 Connect couplings to hot and cold supply lines. Use copper tubing or galvanized pipe (I.P.) Stop valves must be open before soldering.

5 Outlet attachment

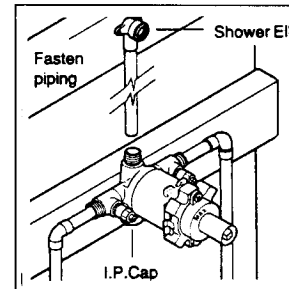

1 Install shower ell to top of outlet valve using either 1/2" copper tubing or 1/2" threaded pipe.

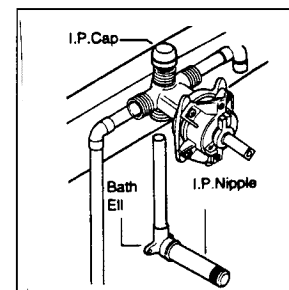

2 Install 1/2" copper tubing directly to bottom of valve or connect with 1/2" coupling and threaded pipe.

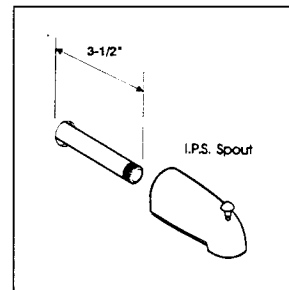

3 After wall is finished, install 1/2" nipple to extend 3-7/8" beyond finished wall. Install spout.

6 Trim assembly

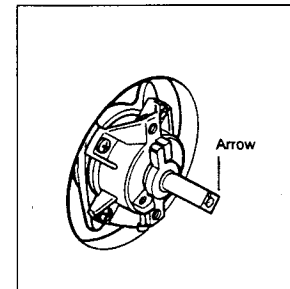

1 Remove plaster shield and discard. Rotate them stem so arrow on the stem and points to the "OFF" position on valve cap.

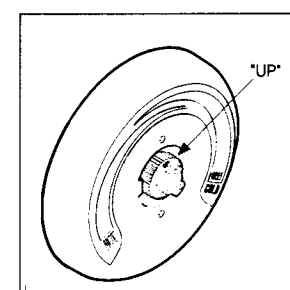

2 Rotate the stem driver in the middle of the escutcheon to the marked "UP" position.

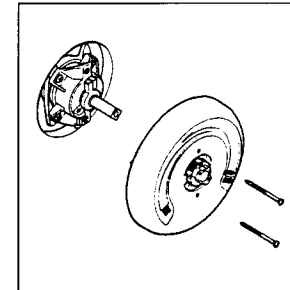

3 Slide escutcheon assembly over stem and push against wall. With two long screws, fasten firmly.

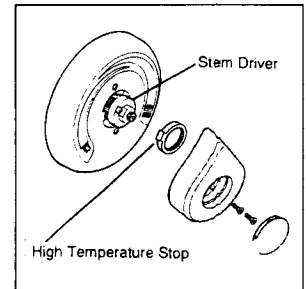

4 When using the High Temperature Stop, place the transition escutcheon over stem and align two screws. Position handle on stem, insert handle screw and tighten firmly.

NOTE: When placing the High Temperature Stop over the stem driver, move the Stop left for hot and right for cold, to set a limit for the desired water temperature.

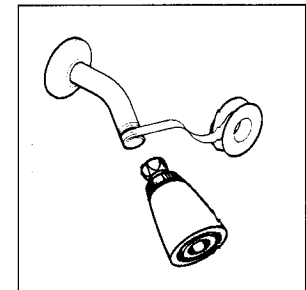

5 Install shower arm and flange. Use teflon tape and strap wrench to seal and tighten shower head to shower arm. Take care to protect finish.